



**Linee Automatiche  
di Frittura e  
Bollitura**  
dal 1981

*più di 30 anni d'esperienza*



## **INDUSTRIAL DRUM WITH SPRAYING SISTEM**



### **FEATURES:**

- Speed rotation of the drum adjustable by knob;
- Electronic system for liquid nebulization (water, oil, etc.);
- Touch screen display for setting types and times of spraying;
- Quantity regulation of liquid sprayed;
- Tank containing 18 liters equipped with visual control;
- Removable drum for easy cleaning, even with pressure washer;
- Frame with swivel wheels with brakes and height adjustable for better stability if there is uneven floor;
- Drum and parts in contact with the product made of stainless steel AISI 316, while the structure is made of stainless steel AISI 304;
- Safety devices according to law;
- Machine with CE marks;
- Supply voltage to 230 V, power consumption of 150 W;

## TECHNICAL FEATURES:

- Overall dimensions cm 176x174x160;
- Structure and components built entirely with materials suitable for food contact;
- Sprayed oil regulation with touch screen;
- Maximum electric power 300 W;
- Pneumatic panel with possibility to adjust the air pressure;
- Machine built with stainless steel AISI 316 and AISI 304;
- Rotation of the drum invertible, on request;
- Possibility to choose between two types of drum:
  - Drum made in stainless steel AISI 316 - weight  $\pm 55$  Kg
  - Drum made in plastic for food use - weight  $\pm 13$  Kg

## DIMENSIONS:

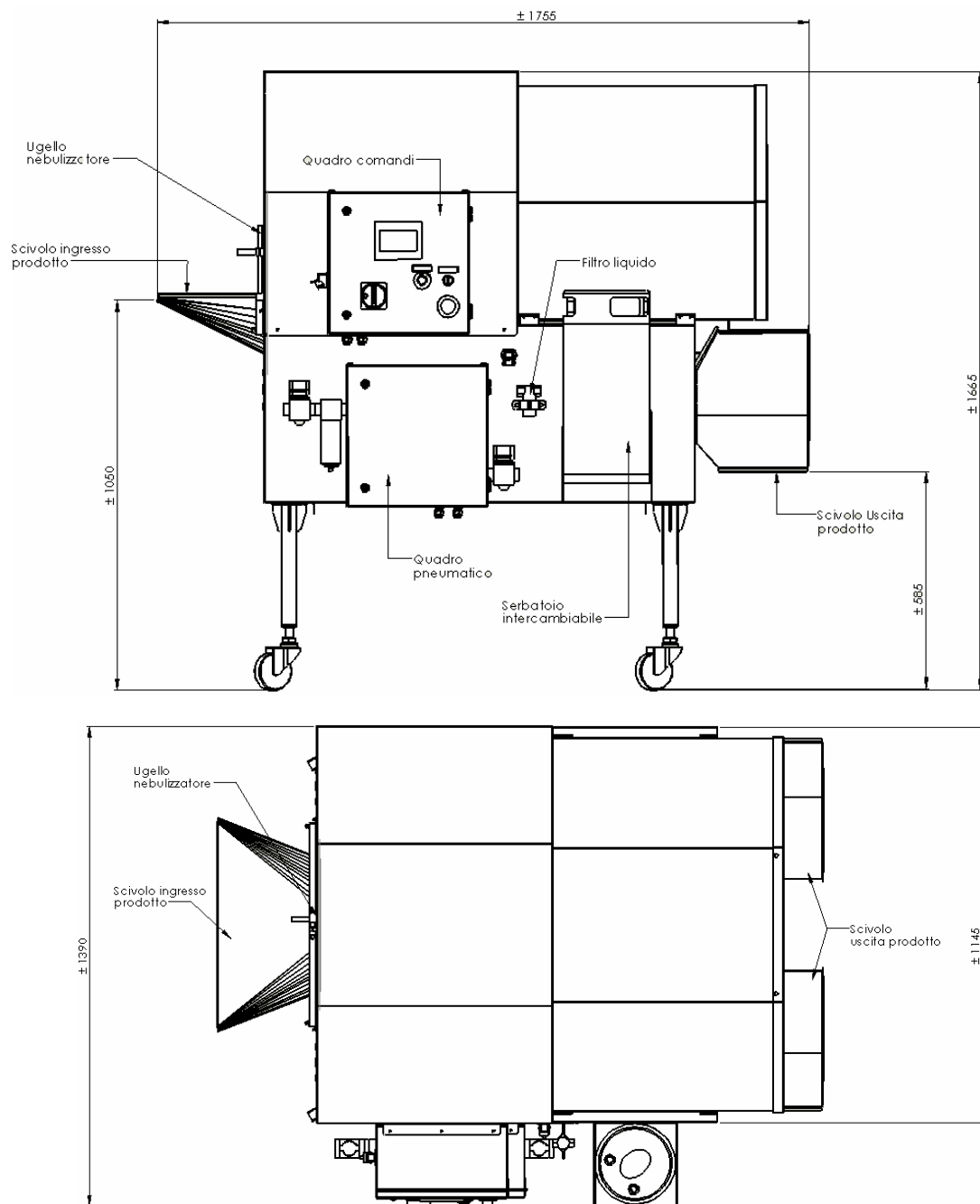

For the purpose of improve the product, the manufacturer can change the measurements without notifying the customer.